

NOTES FOR INFORMATION:

- KEY:**
- Land (Title) to be acquired
 - New Rights (Easement) to be acquired

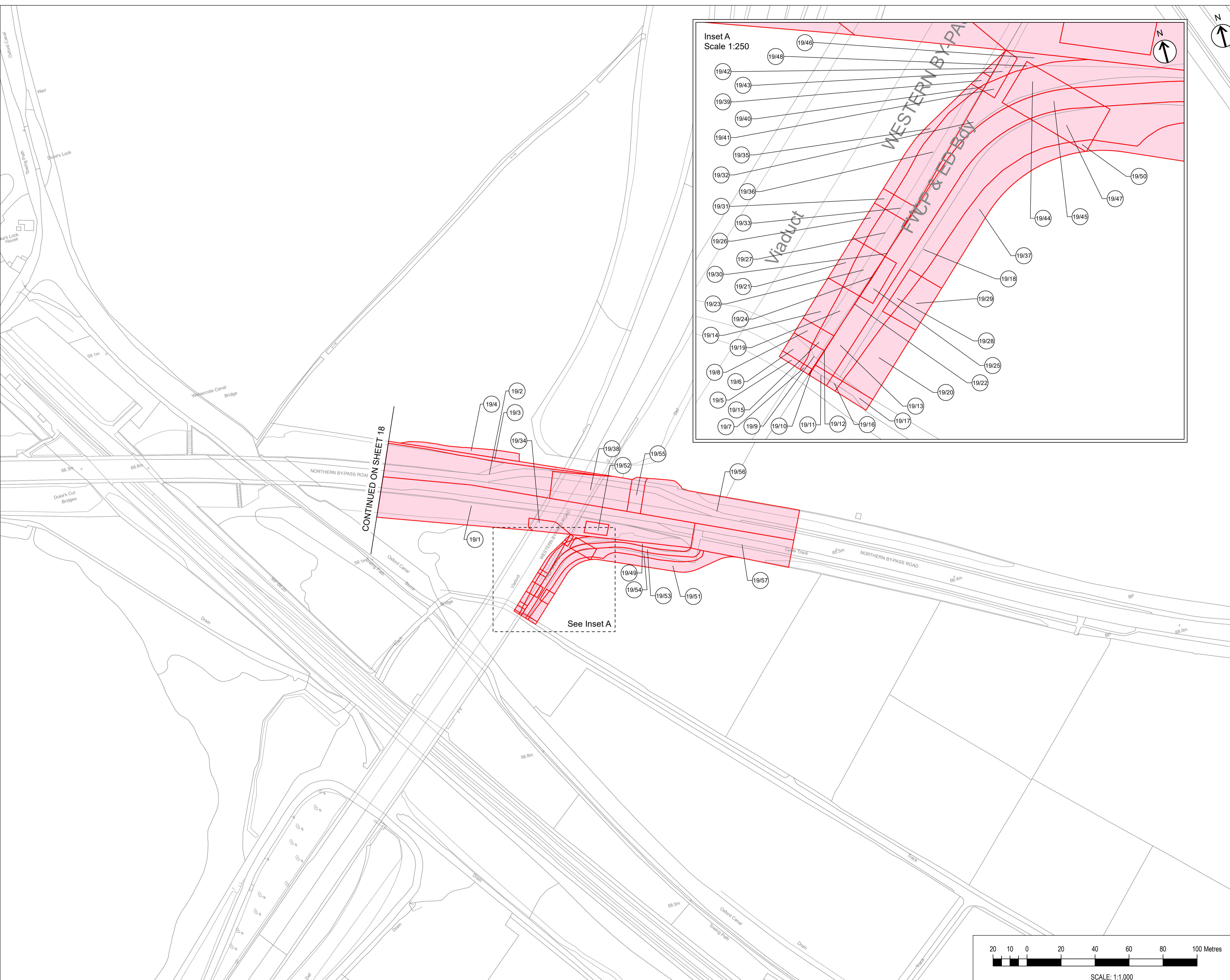
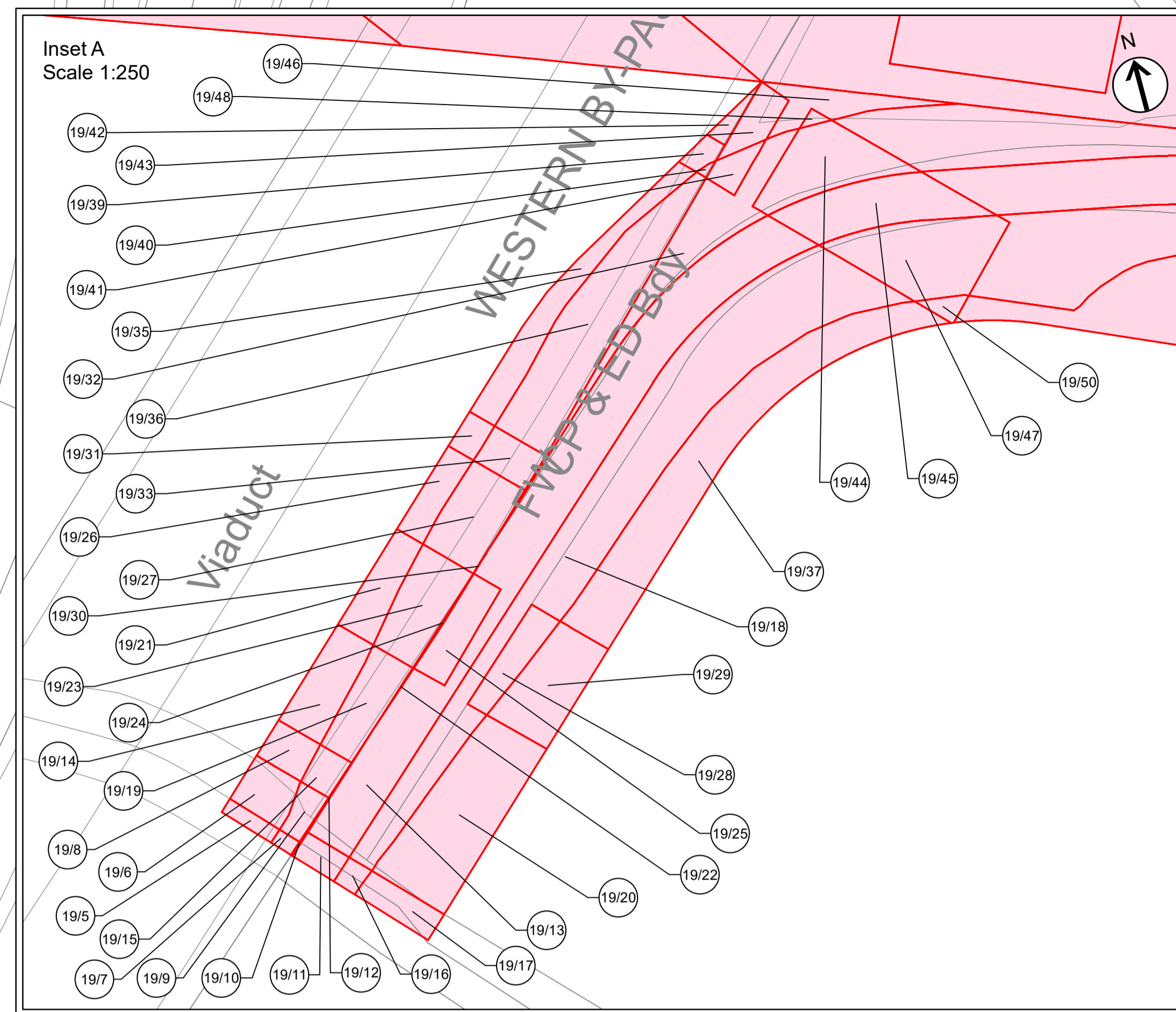

CONTINUED ON SHEET 18

See Inset A

Rev	Description	Date	By	Check	Approved
P01	First Draft	10/01/22	LH	**	**

This map is reproduced from Ordnance Survey material with the permission of Ordnance Survey on behalf of the Controller of Her Majesty's Stationery Office. © Crown Copyright. Unauthorised reproduction infringes Crown Copyright and may lead to prosecution or civil proceedings. Oxfordshire County Council, 010022343, 2021



THE OXFORDSHIRE COUNTY COUNCIL
 (HIGHWAYS INFRASTRUCTURE – A40
 HIF2 SMART CORRIDOR
 (HILL FARM TO DUKES CUT))
 COMPULSORY PURCHASE ORDER

SHEET 19 OF 19
 A40 DUKES CUT – RAILWAY CROSSING AND OXFORD
 CANAL CROSSING TO EAST OF UNDERPASS
 CROSSING OF A34 WESTERN BYPASS, AND NEW
 CYCLE TRACK LINK

The COMMON SEAL of
 Oxfordshire County Council
 was hereunto affixed in the
 presence of –



Authorised Officer
 Dated this day of 2022 Seal No.

Drawn	Checked	Approved	Date
LH	**	**	10/01/22

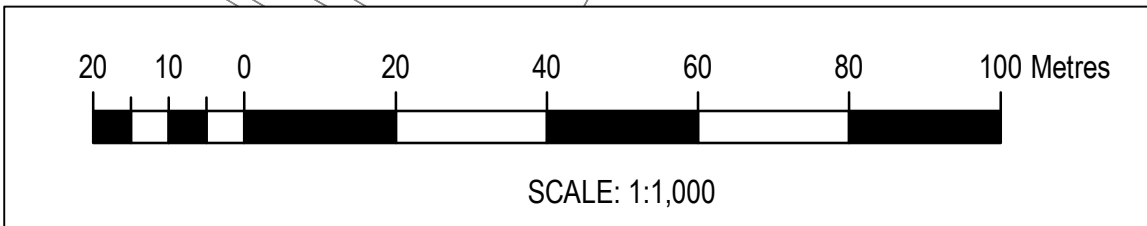

GH Project Number	Scale at A1
132861.005	1:1,000
Drawing Number	Revision
GH-132861005-CPO-19	P01